



**LOZOVA
MACHINERY**

***MAKE YOUR
MONEY WORK***





LOZOVA MACHINERY produces a wide range of up-to-date cost-effective tillage implements, seeding machinery and tipping trailers.

We have:

- More than 30 tillage units in the product line
- A range of modern machines with unique design features
- Sales to more than 22 countries in North America, Europe, and Asia
- Over 100 exhibitions, demo-shows and Field Days annually
- Three production sites

Our core strengths:

- better and faster tilling
- zero maintenance
- no downtimes and repairs
- fuel saving

SHORT DISC HARROWS - DUCAT

LOZOUA  MACHINERY



6 - 8 m



min 300 hp



min 12 ha/h



724 mm



Speed stubble peeling - the operating speed can reach 20 km/h (12,43 miles/h)

SHORT DISC HARROWS - DUCAT



Presowing tillage - the precise depth of processing and excellent leveling are maintained

SHORT DISC HARROWS - DUCAT

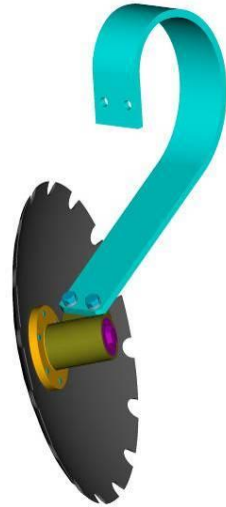

The main design feature of Ducats is a spring tine, which provides:

- reduction in traction resistance of the implement and its fuel consumption by at least 20%;
- 3D-protection of the bearing unit when hitting any obstacles, which precludes the breakage of disks, bearings, racks, and the damage to the frame;
- uniform processing depth, due to the elimination of the hollowing out of the entire unit when hitting one disc with an obstacle;
- self-cleaning of the discs during the work process, which allows to work effectively on wet soils



Rigid disc harrow



Disc harrow DUCAT



DUCAT spring-mounted disc harrows have a significant advantage over battery-powered or rigid tines, which is shown in a much greater stability of the depth of the sowing bed and much less combing



SHORT DISC HARROWS - DUCAT

Cage Roller

Universal roller for all soil types



Packing Tooth Roller

For overdried soils of all types



Double U Roller

For all soil types with a large number of plant residues



Rubber Roller

For presowing preparation



Packer Ring Roller

For wet soils of all types



Depending on the working width, five options for rollers are available for DUCAT



The cage roller does not have a central axis, so it does not clog even under the waterlogged conditions and in conditions of extreme weediness of the field.

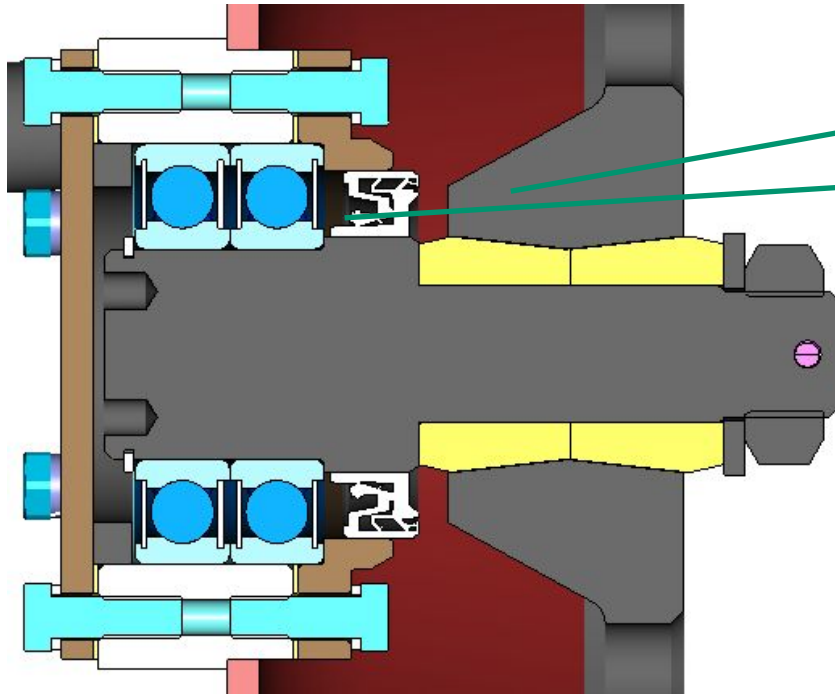

The cage roller bearing hub, as well as the disc bearing unit, is maintenance -free for the entire service life.

The bearing hub has:

- 1) high-quality cartridge seal;
- 2) high quality HARP sealed bearings.

The axis of the roller is connected to the frame through rubber dampers, which further reduces the load on the bearing hub of the roller.

HEAVY DISC HARROWS - DUCAT GOLD



6 - 8 m



min 300 hp



min 12 ha/h



724 mm

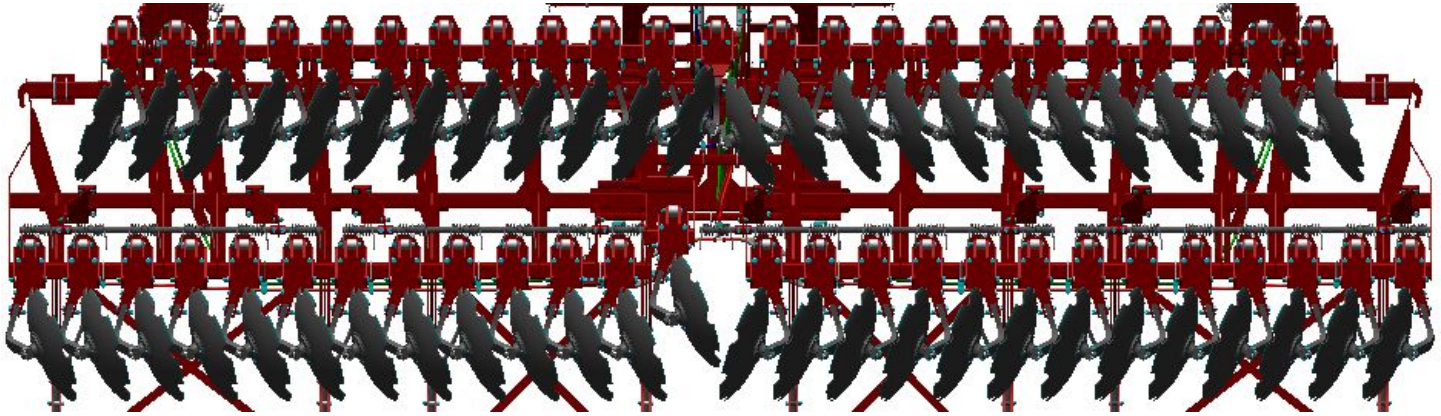

Symmetrical arrangement of discs relative to longitudinal axle completely prevents any lateral drift regardless to the operation depth.

Front discs work as throw-out and rear discs - as throw-in (X-shape).

HEAVY DISC HARROWS - DUCAT GOLD



Rollers with diameter of 600 mm (23,6 inches) provide good load-bearing capacity on light soils. Rollers are equipped with maintenance-free bearing units HARP AGRO UNIT.

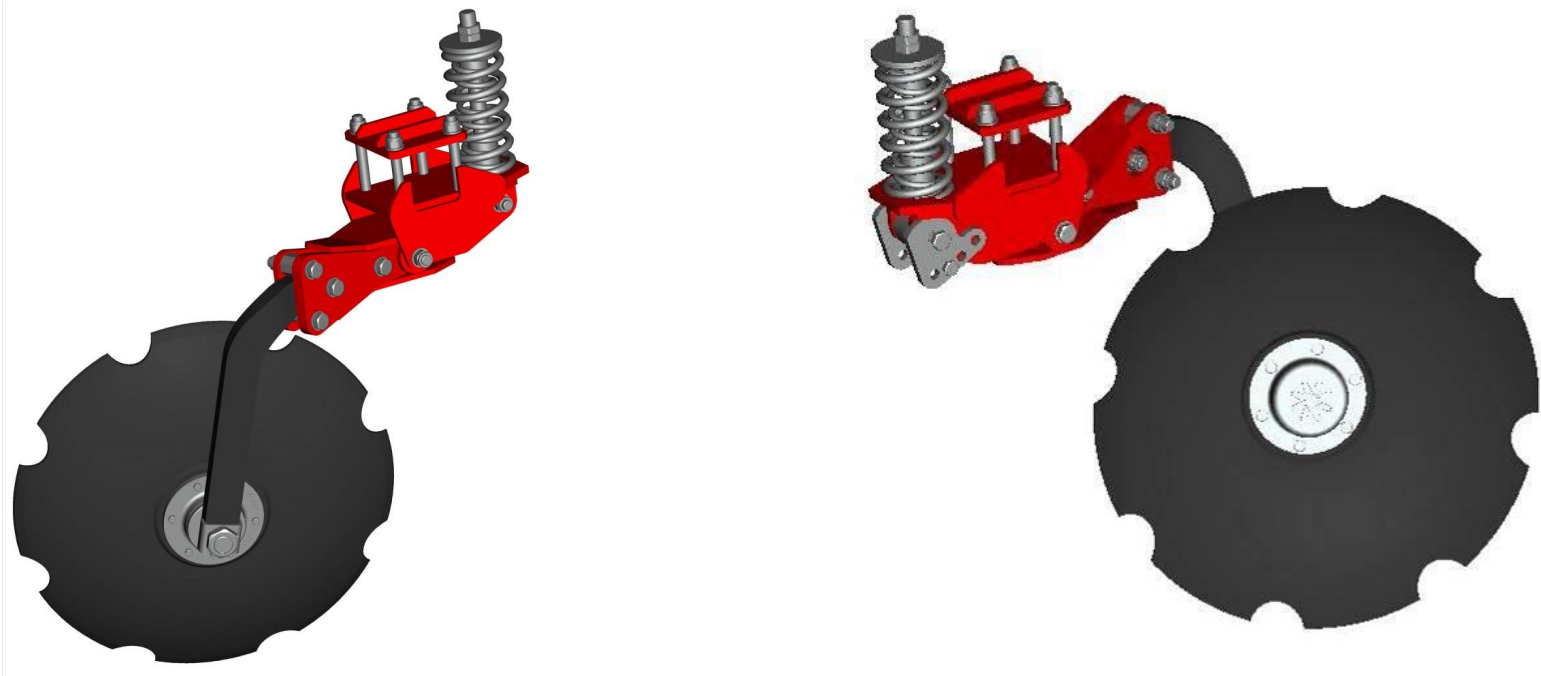

Spring-loaded tine has a load of 260 kg (573,2 pounds) per disc allows for a full heavy stubble breaking in one pass for primary and medium tillage

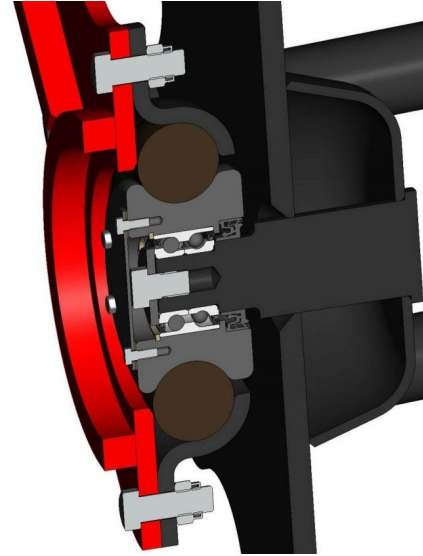
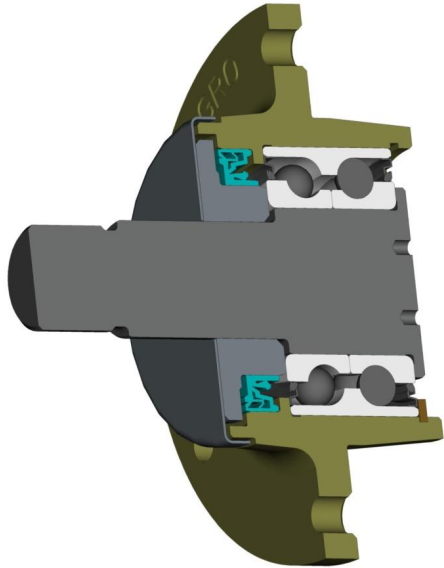

Bearing unit of disc (HARP AGRO UNIT with a three-level protection) and bearing unit of roller do not require any maintenance during entire service life.

SUBSOILERS - FRANC

LOZOVA  MACHINERY



2,5 - 4 m



min 160 hp



up to 4,18 ha/h

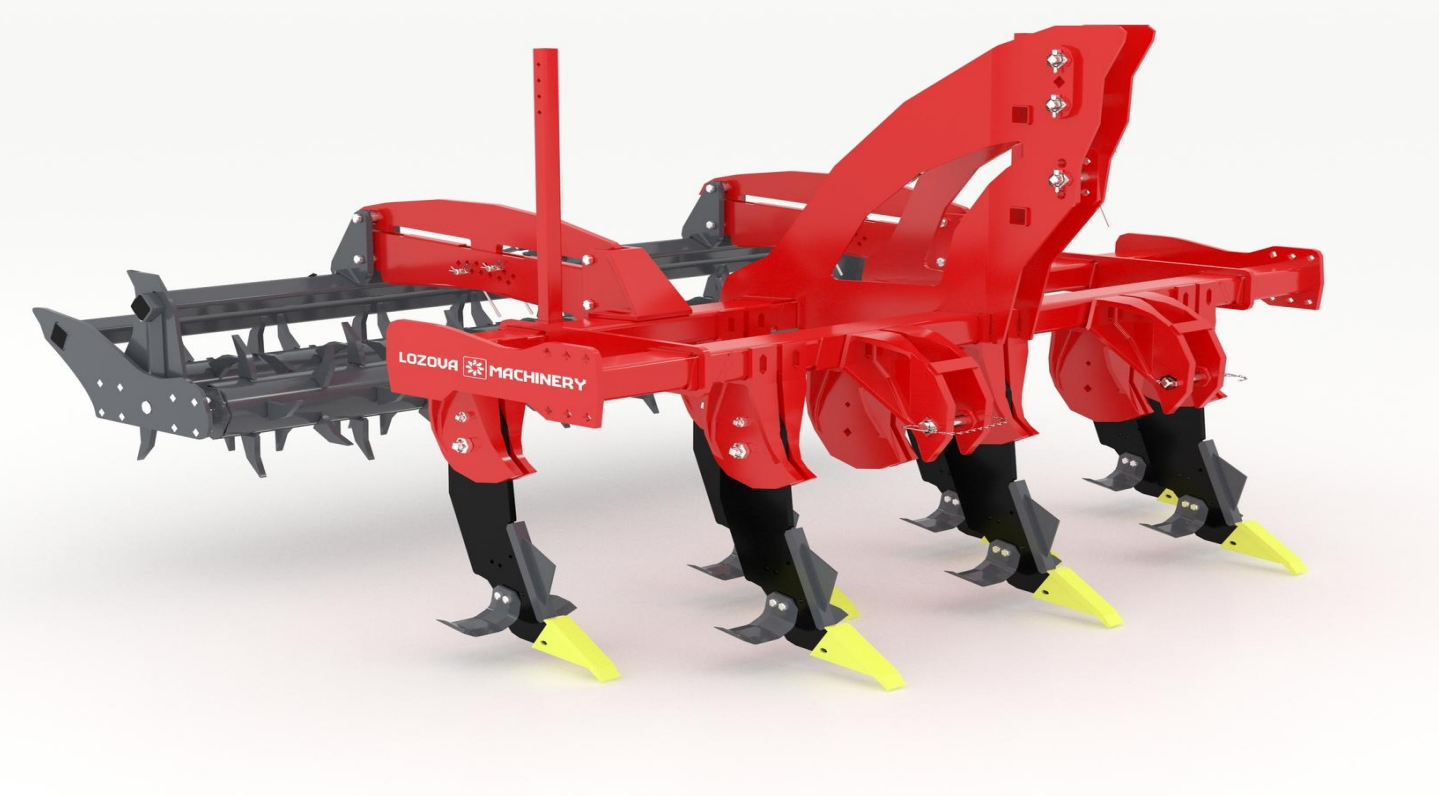

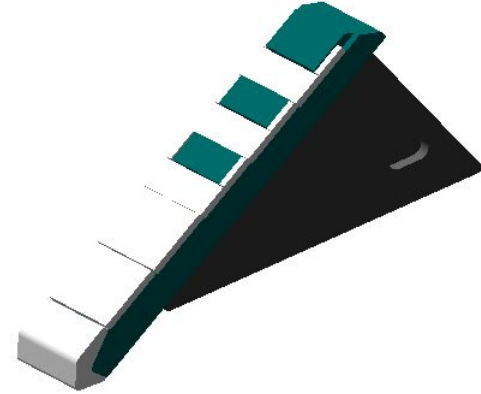
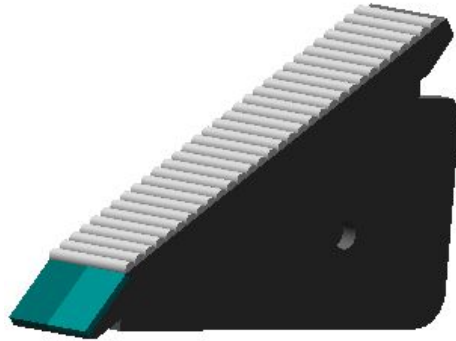

FRANC subsoilers can be equipped with one of three types of chisel points:

- 1) base welded with flat carbide tips and welding-on along the point body;
- 2) casted point with flat carbide tips;
- 3) casted with carbide tips and body covered with carbide plates.



Double self-cleaning roller with balanced suspension

Equipped with maintenance-free HARP flange bearings (sealing system - X-SHIELD)

- deep loosening of the soil without turnover of the soil;
- destruction of the plow sole;
- improvement of water-air regimes in the soil.

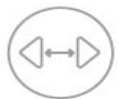

2,5 - 4 m



min 160 hp



up to 4,18 ha/h



Special frame design

Deltaic frame is made of shaped tube in the form of an isosceles triangle, which redistributes pressure and reduces loads on the frame



Two rows of tines – double soil cultivation

First row is designed for deep soil cultivation to the depth up to 45 cm (17,7 inches).

Second (additional row) is designed for intensive top mulching to the depth up to 25 cm (9,8 inches).

SPRING-TOOTH HARROW - LIRA

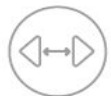

15-24 m



min 80 hp



up to 12,1 ha/h



LIRA is applied for:

- early spring harrowing for crust destruction and encouraging the weeds germination;
- weeds destruction in the “white fiber” phase;
- moisture retention by means of interruption of capillary flow from the substrate;
- even distribution of stubble remains on the field;
- incorporation of seeds and mineral fertilizers, distributed across the field;
- overall tillage when handling the fallow lands and seedbed preparation when fall-ploughing;
- windrowing of straw and hay.



Lifetime of the teeth wear

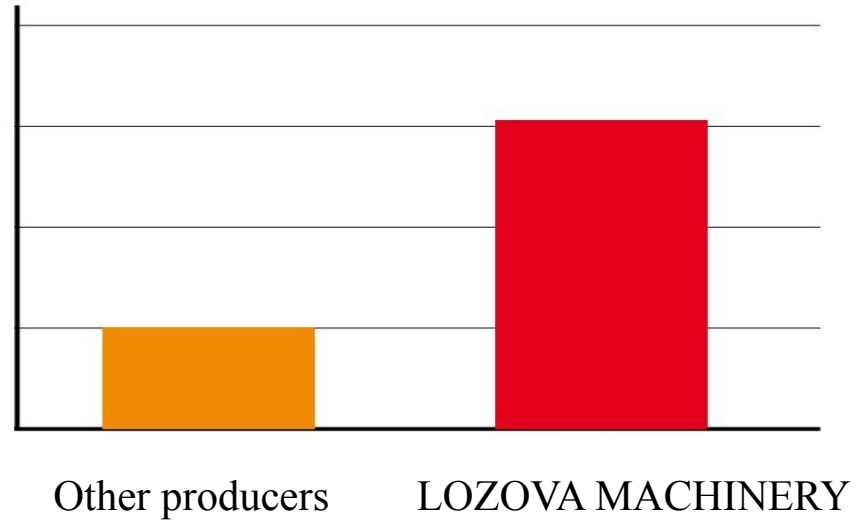

Harrow spring tooth is made of high-quality special steel with special heat treatment, general volumetric hardening, additional hardening of high-frequency teeth ends is 51 to 57HRC.

HEAVY TOOTH HARROW - LIRA XL

LOZOVA  MACHINERY

5 DIFFERENT OPERATIONS IN ONE
PASS



15-21 m



min 170 hp



min 21 ha/h

HEAVY TOOTH HARROW - LIRA XL



Simultaneous early spring harrowing and loosening of topsoil to a depth of 2-10 cm (0,79 - 3,94 inches) allows for:

- keeping moisture;
- encouraging germination of weeds to be destroyed;
- leveling the soil and preparing it for seeding;
- incorporating fertilizers and pesticides;
- uniformly distributing stubble remains.

HEAVY TOOTH HARROW - LIRA XL



Parallelogram suspension of separate work sections allows to keep contact with a rough soil. So the working width and the field contouring are higher than with the leaf spring suspended sections.

The pressure of springs on the field surface is adjusted by wrap springs.

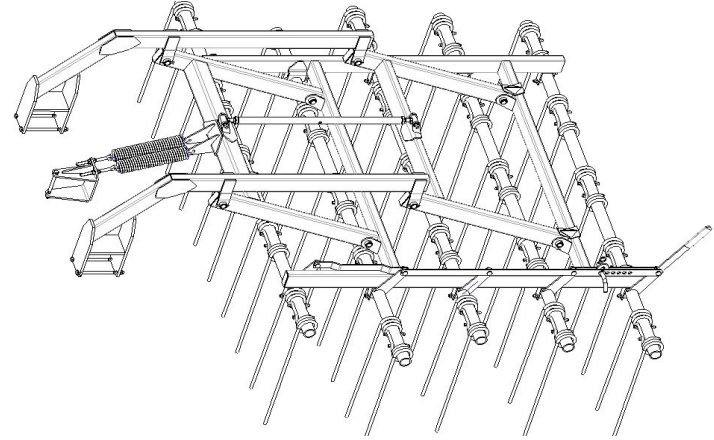

Construction of working sections:

- working sections consist of five rows of the offset spring teeth with spacing;
- the teeth tilt angle is adjusted for the entire section with limits from 45° to 90° , and an interval of 15°

Constructive advantages:

- position of spring teeth provides high quality of tillage without non-cultivated areas;
- adjustable teeth tilt angle changes the pressure on the tooth and the tillage depth from 2 to 10 cm (0,79 - 3,94 inches);
- the spring-adjusted pressure of sections allows to adapt the harrow for light and for heavy tillage.



Lifetime of the teeth wear

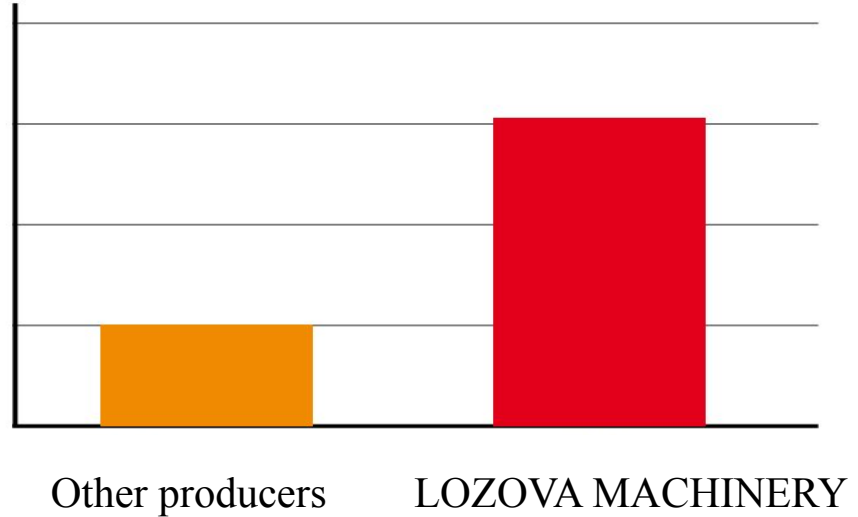

Spring tooth:

The tooth of harrow is 16 mm in diameter and 820 mm in height (from the axis 762 mm) is made of high quality steel with a special heat treatment, general bulk hardening, additional HFC hardening of ends is 51 to 57 HRC.

HEAVY TOOTH DRAG HARROW - LARI



14,6-21 m



min 170 hp



min 21,4 ha/h

- Seedbed preparation on the previously ploughed background.
- Moisture retaining.
- Destruction of weeds in the “white thread” phase

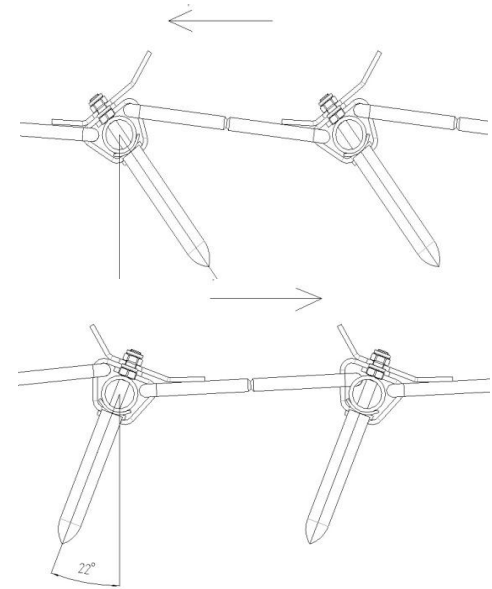

Construction of working sections:

- working sections consist of sixteen offset teeth rows set on the shafts with spacing;
- there are two tilt angle types depending on the sections movement direction

Constructive advantages:

- positioning of spring teeth provide high quality of tillage without non-cultivated areas;
- adjustable teeth tilt angle allows to control intensity of tillage depending on the task



Lifetime of the teeth wear

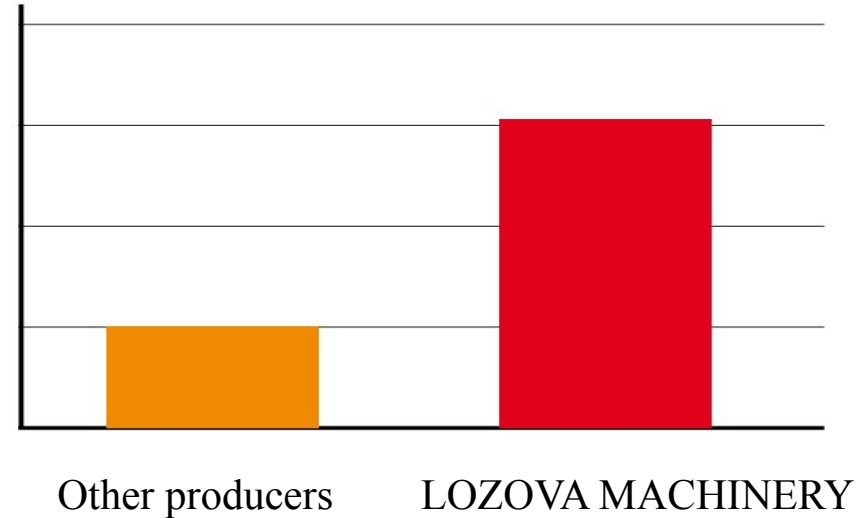

These are the most durable teeth on the market, made of spring steel with high solidity of working surface (55 to 60 HRC)

HEAVY TOOTH DRAG HARROW - LARI

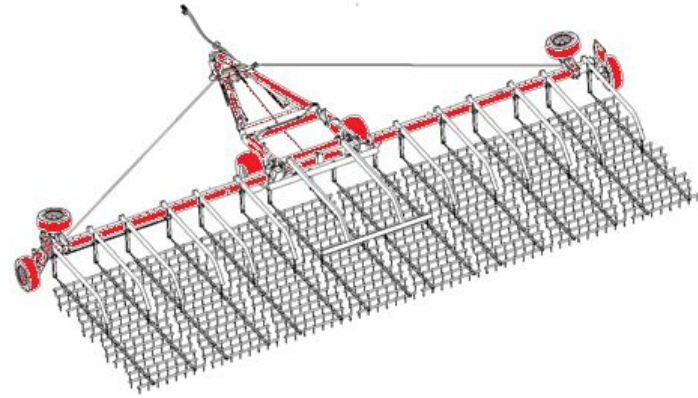
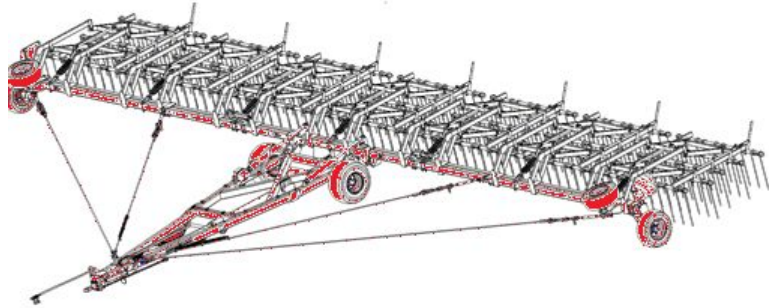

The LIRA XL and LARI implements have unified main frame constructions that make it possible to convert heavy spring harrow into drag harrow and vice versa.

Therefore, if you buy ONE implement and a special re-equipment set, you get TWO implements and save your money.

ROTARY HARROW - DINAR

LOZOVA  MACHINERY



6,4 m



min 110 hp



min 12,8 ha/h



Pre- and post-harvest harrowing to close moisture



Soil aeration

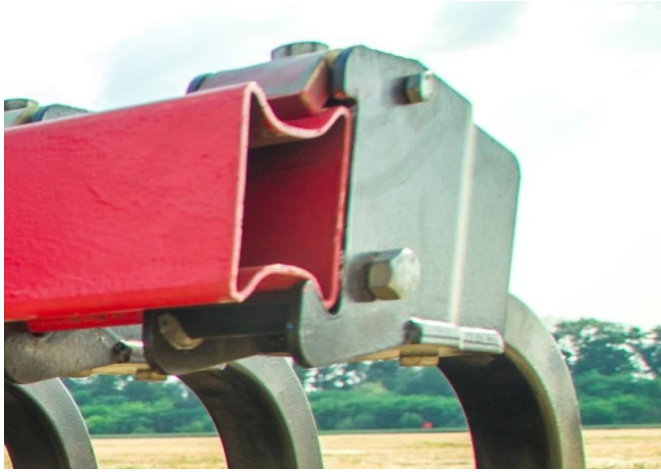

Each tine is mounted to the frame with one bolt. Such fast mounting reduces the efforts when changing tines for different inter-rows.



Precise tines pressure on a soil is provided by two springs and two-stage compression, which keeps required depth during work.



Balance mounting of stars provides contact with a soil, reducing dynamic loads on bearings.

The special form of teeth top provides better tillage.



The star with oblique teeth, depending on chosen mounting, provides vertical teeth penetration of the soil with minimum damage to plants and effective soil saturation with oxygen. Also, these teeth increase the pressure on the soil for more intensive tillage.

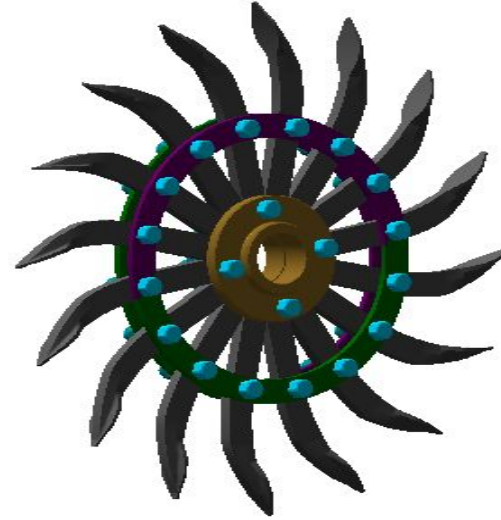

Two types of stars with diameter of 534 mm (21,03 inches):

1. A star is made of high-strength cast iron – powerful universal star for working on all soil types;
2. A built-up star with forged teeth – for working on rocky soils with possibility of changing separate teeth.

ROTARY HARROW - DINAR



Harrow is equipped with additional support wheels which help to control penetration of stars into the soil.

FIELD CULTIVATOR - FLORIN

LOZOVA  MACHINERY



6,4 m



min 110 hp



min 12,8 ha/h

FIELD CULTIVATOR - FLORIN



One of the longest frames in its class for no-clogging work.

The distance between the rows of racks is 850 mm (33,46 inches)

The distance between the first and the last row of racks is 4050 mm (159,45 inches).



Three options of racks: spring, spring-loaded and spring square.

A client can choose any set depending on the required work and their specific field conditions and tasks.

FIELD CULTIVATOR - FLORIN

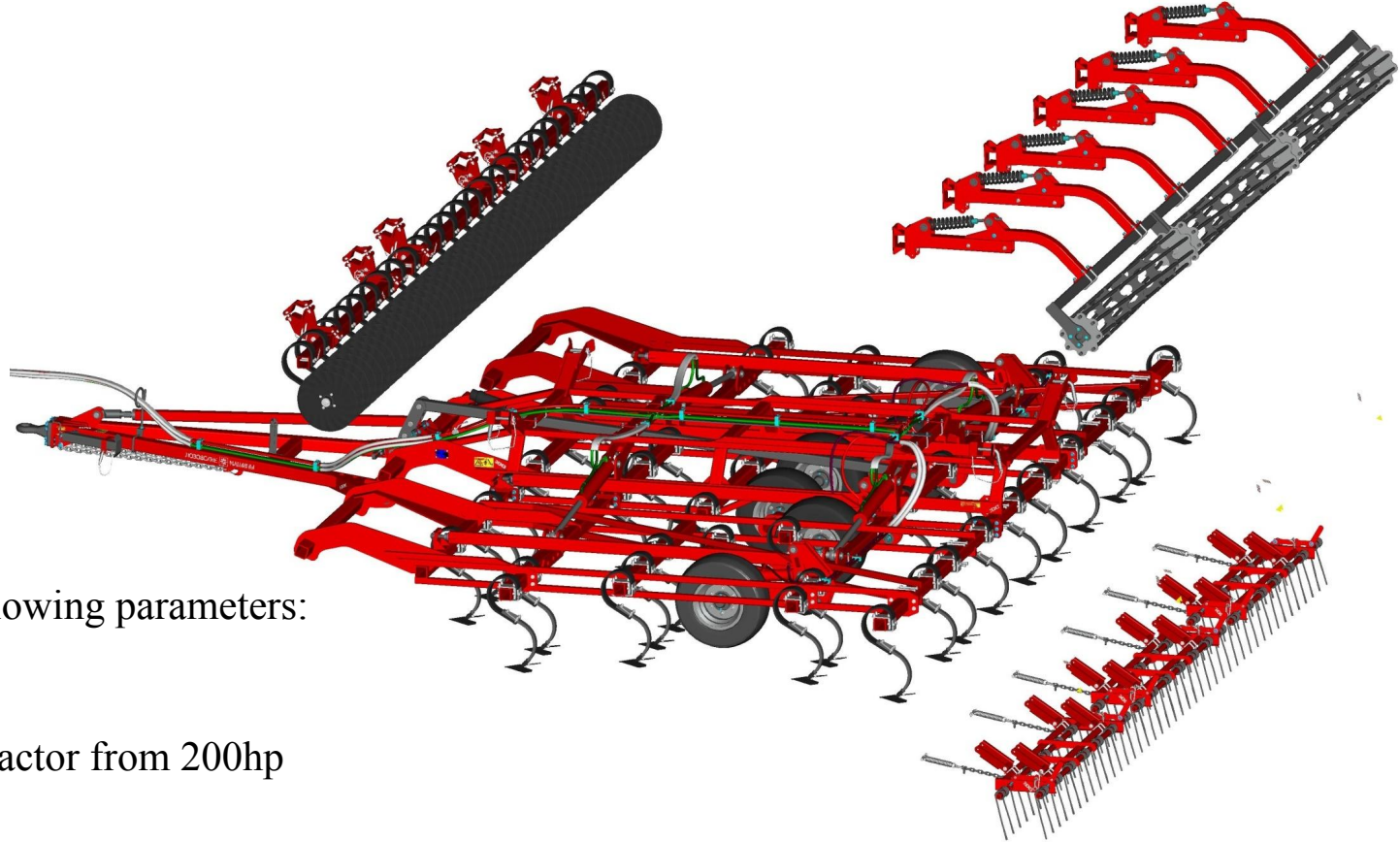

This machine has the following parameters:

- Working width - 8m.
- Aggregation with a tractor from 200hp
- Five rows of racks.

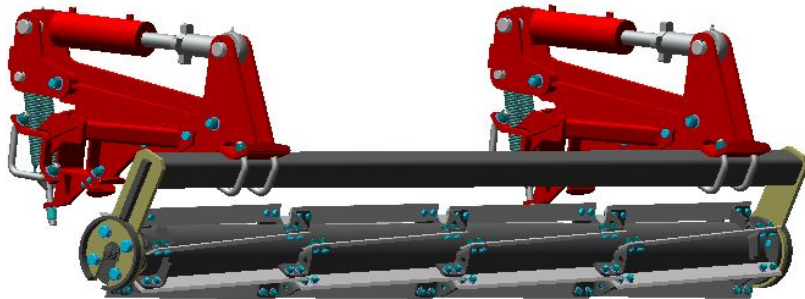

Optional installation of the chopping roller for over-cross on any stubble, in addition to the front cutting disks.

FIELD CULTIVATOR - SANTIM

LOZOVA  MACHINERY



6,4 m



min 110 hp



min 12,8 ha/h

FIELD CULTIVATOR - SANTIM

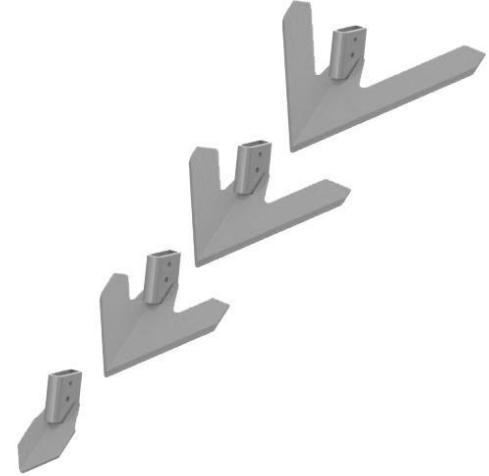

The ability to easily and quickly change the width of the working section in the range from 30 cm to 70 cm (11,81 to 27,56 inches).

Use of a spring rack allows to reduce fuel consumption.

A choice of quick-change tabs with a width of 150 mm and 200 mm (59,06 to 78,74 inches).



Optional installation of the liquid fertilizer system

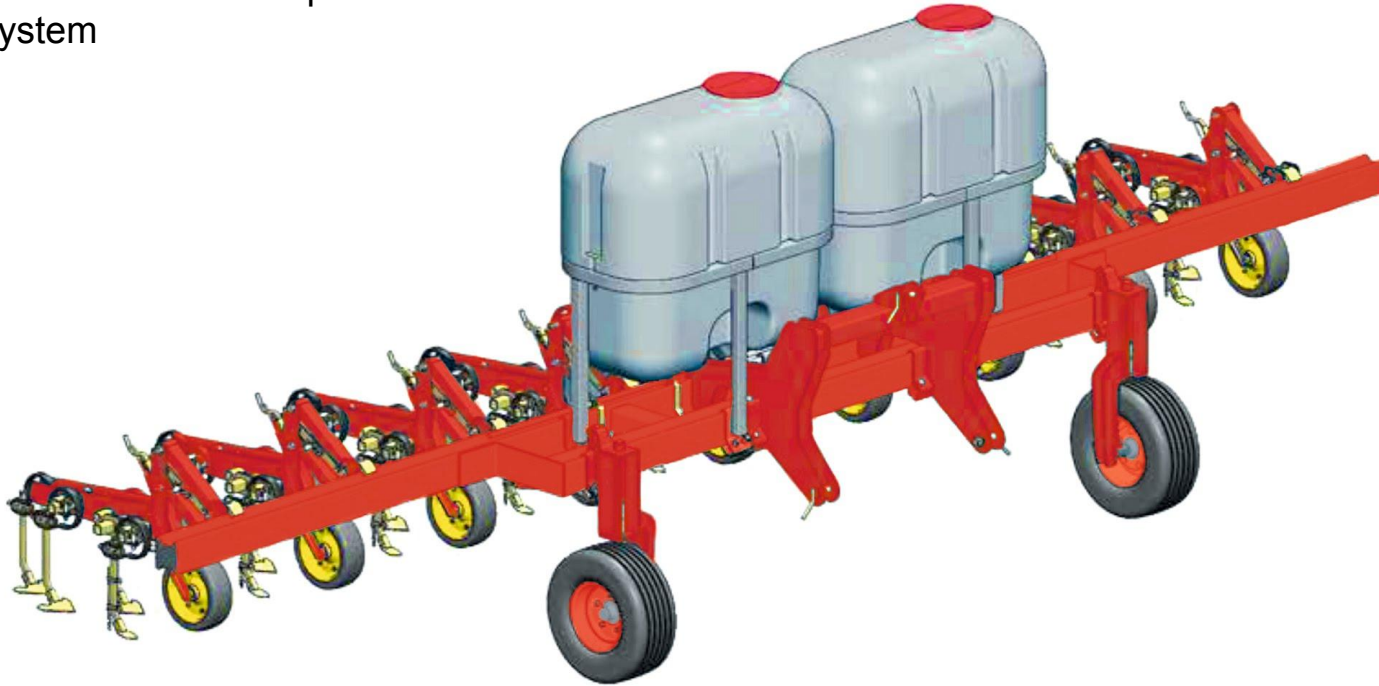



| | |
|------------------------------|------------|
| Engine power, hp, min | 170 |
| Body volume, m ³ | 26,0 |

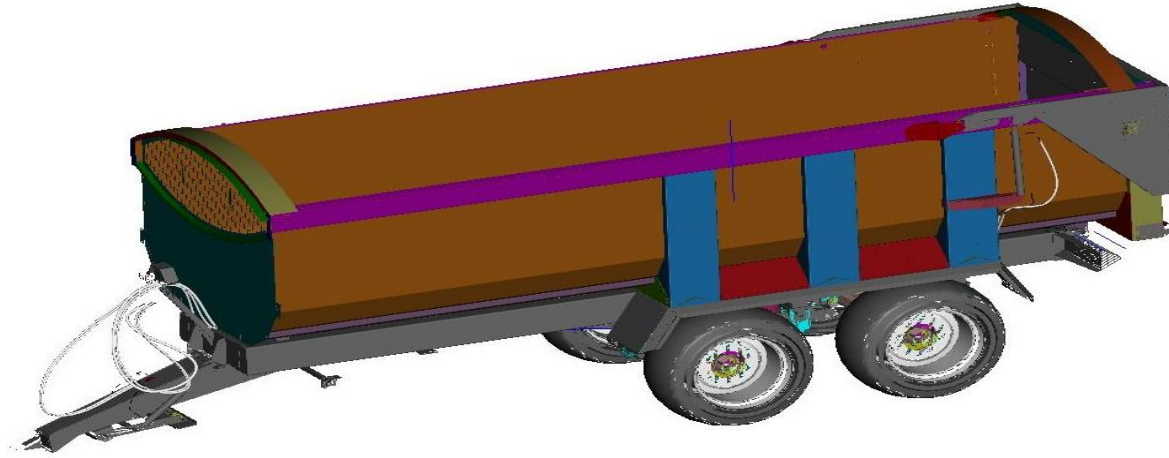

- Type of trailer – tipping with back unloading.
- Body volume 26 sq.m (85,30 sq. feet), with extension sides 37 sq.m (121,40 sq. feet).
- Carrying capacity 20 t.
- Aggregation with a tractor from 170 hp
- Full compliance with transport and traffic rules for overall dimensions

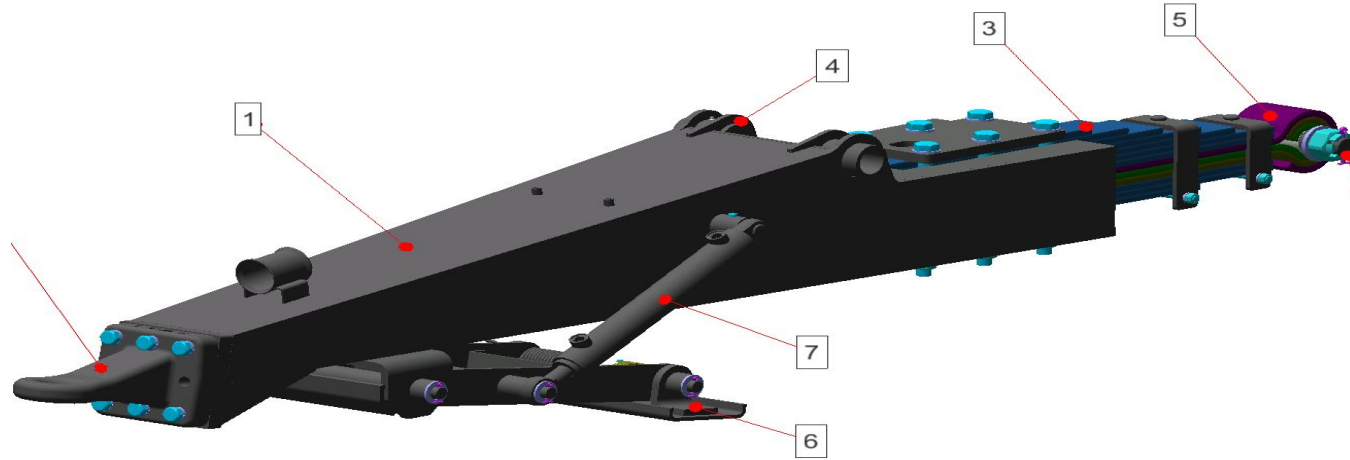

The sprung drawbar can significantly reduce dynamic loads during acceleration and braking of the trailer.

The hydraulically controlled drawbar support makes it easier to control the height when mounted with the tractor.

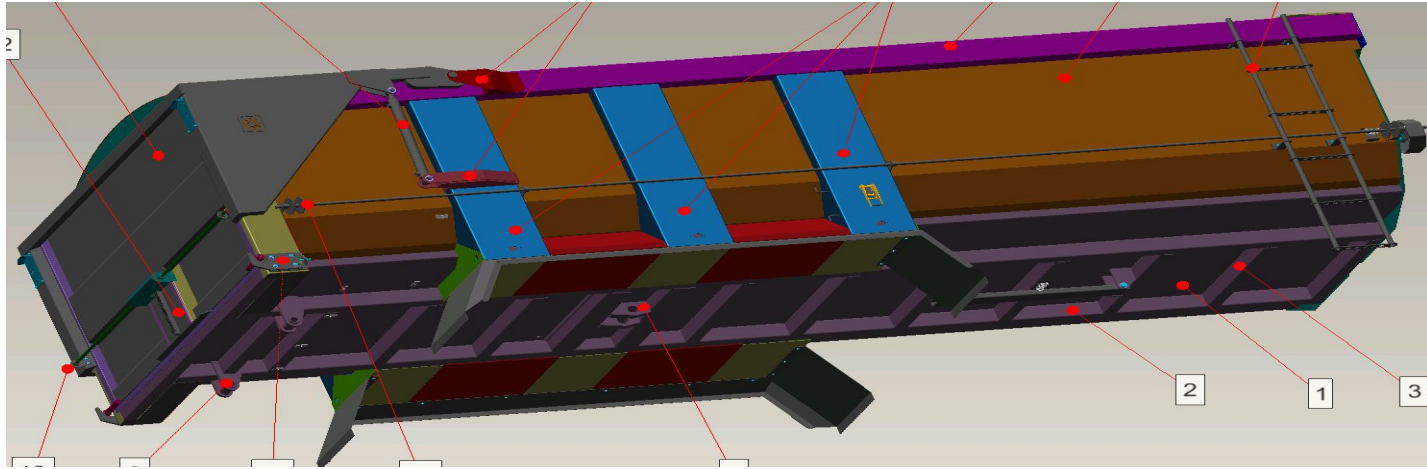

This trailer has one of the strongest bodies in its class.

The thickness of the body sides is 4mm, the thickness of the bottom is 6 mm (0,16 inches).

Given the thickness of the reinforcement tubes under the bottom, the total thickness of the bottom is 12 mm (0,47 inches).

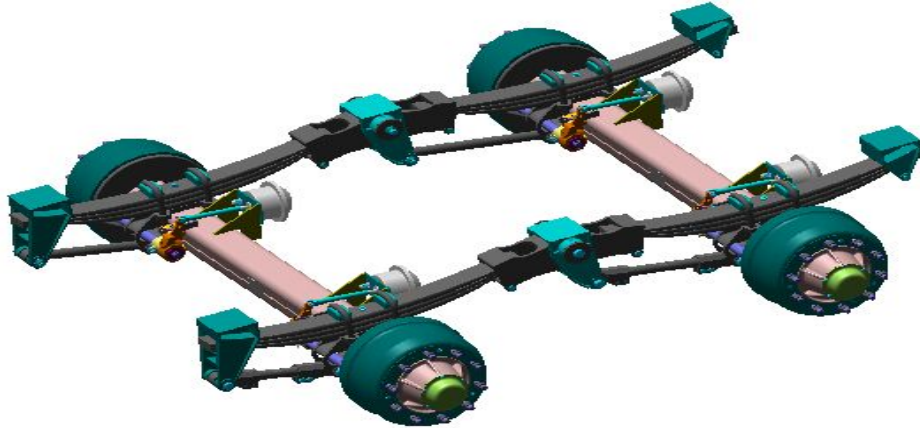

Balance tandem suspension of axles with 100 mm (0,39 inches) spring.

Reinforced axles with full lip seal of the hub cavity to prevent the ingress of abrasive and dirt to the bearings.



Large front viewing window for convenient visual inspection of trailer filling from the tractor cab.

Gate for the dosed unloading of bulk materials



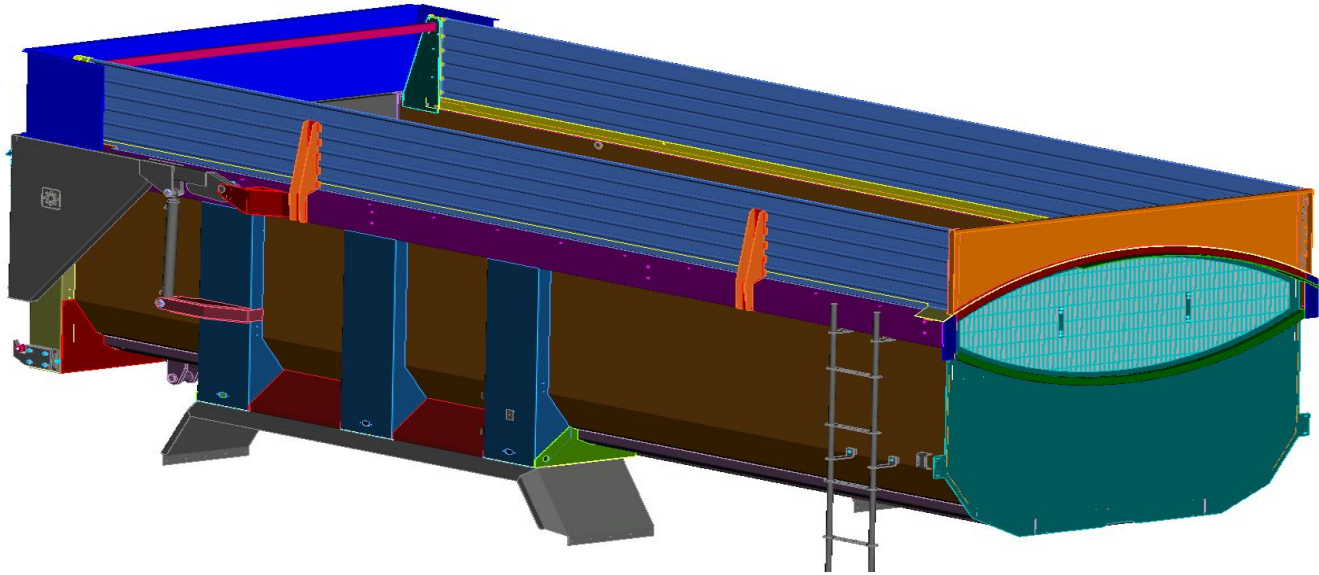

As additional options, add-on sides are available for light bulk cargo.



Optional screw installation for grain overload.
Full body overload time - 2min, full body with extension sides - 3min.



- ❑ Body volume 26m³, with add-on sides 37m³
- ❑ Awning to protect goods from weather
- ❑ Huge front window
- ❑ Sprung drawbar
- ❑ LED lighting
- ❑ The strongest frame in the segment
- ❑ Hydraulic parking support control
- ❑ Super tread wheels
- ❑ Slatted gate for metered discharge
- ❑ Reinforced axles
- ❑ Full compliance with traffic regulations on dimensions
- ❑ Tandem suspension based on spring width 100mm
- ❑ Optional ∅ 550mm screw installation for grain overload



TRACTOR SEMITRAILER - KELT



| | |
|-----------------------|------|
| Engine power, hp, min | 170 |
| Body volume, m3 | 28,0 |

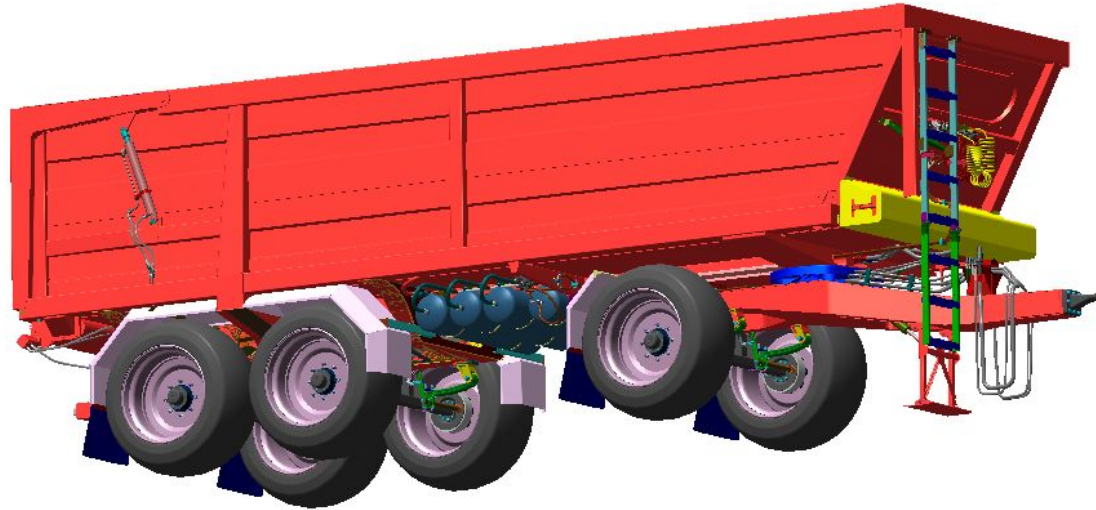

- Type - tractor semi-trailer with unloading back.
- The volume of the body is 28 m³, with extension sides 400mm - 36m³, 800mm - 43m³.
Carrying capacity 21 t.
- Aggregation with a tractor from 170 hp
- Complete compliance with traffic regulations for dimensions and loads on the axle



Frameless semi-trailer with a supporting body.
The largest body capacity with the smallest weight on the market!



Conveyor belt for fast and safe unloading of any cargo.
Possibility of complete unloading indoors.



A hitch frame with a sprung axle and a bolster body truck. Rear tandem.
Axle load does not exceed 8t.



Wheels have a special tread pattern for the ability to work in high humidity conditions without clogging the wheels.



Has a system for regulating an intra-tire pressure in order to maintain its optimum value both for hard asphalt pavement and for working in the field with minimal rolling losses and minimal soil compaction.



Large front viewing window for good visual control of trailer filling from the tractor cab.



Optional installation of extension boards of 400 mm and 800 mm high for light bulky cargo.

Optional screw installation with a diameter of 550 mm for the possibility of grain overload.

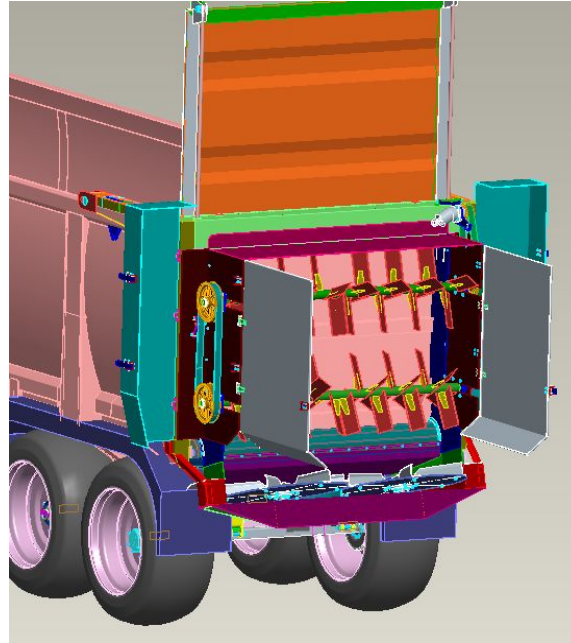

Optional installation of organic fertilizer spreader



- Body volume 28m³, with extension sides up to 43m³
- Full compliance with traffic rules
- LED lighting
- Large viewing window in the front side
- Frameless construction
- Hydraulic parking support control
- Bolster body truck
- Special tread wheels
- Closed Belt Horizontal Discharge
- Intra-tire pressure remote control system
- Optional organic fertilizer spreader
- Optional \varnothing 550mm screw installation for grain overload

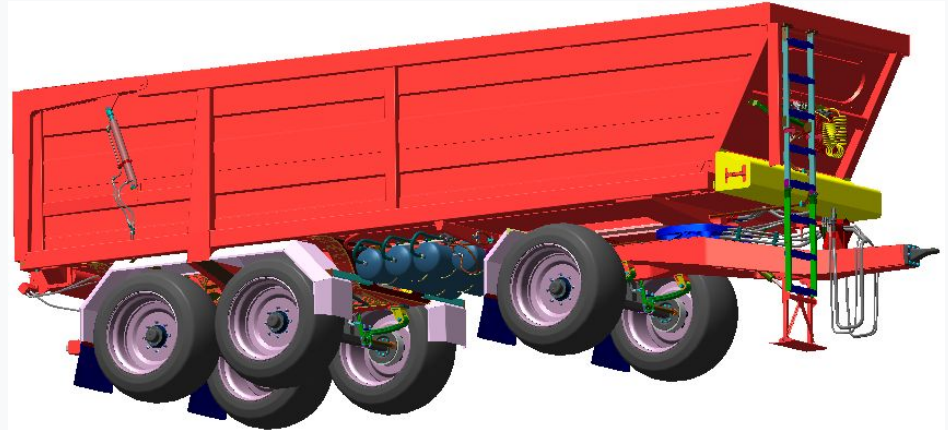

Trailed Sprayer - SPRAYMARC



| | |
|-----------------------|-----|
| Engine power, hp, min | 80 |
| Tank volume, m3 | 3,0 |

Trailed Sprayer - SPRAYMARC



The lightest in the segment all-aluminum boom 24-28m wide can significantly improve its stabilization during operation



Round premix for fast and high quality premixing.
Convenient location of control taps, premix and tank for washing hands.



Stepless track adjustment

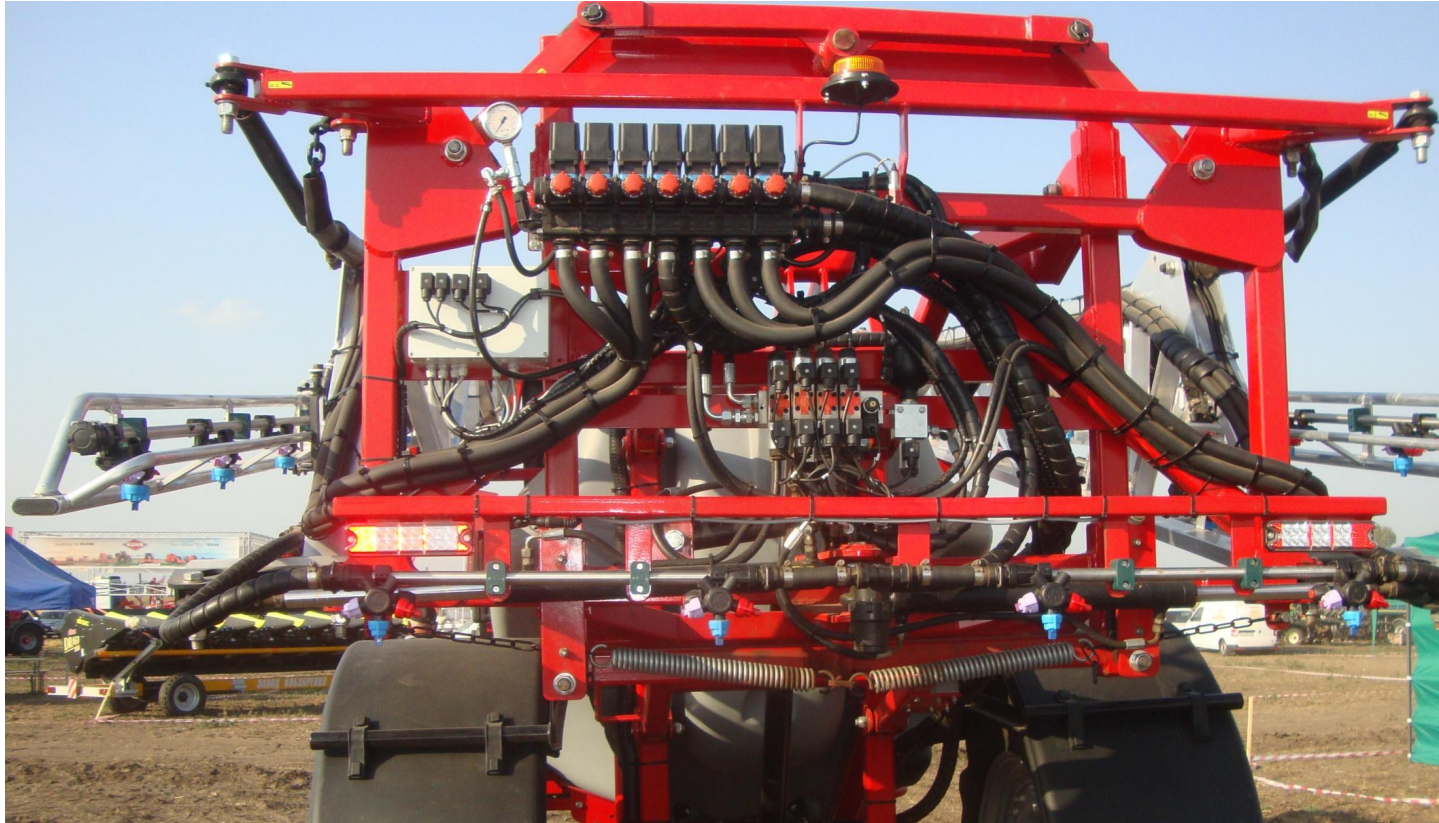

Spring stabilization of the bar.
Electrically control the flow of working solution.



Five nozzle head protected by a boom frame



- The lightest all-aluminum rod 24-28m wide
- 5 nozzle protected head
- 3000 l tank volume
- Convenience of service in operation
- Electronic fluid flow control
- LED lighting
- Spring Stabilization
- Round Premix
- Stepless track adjustment





**LOZOVA
MACHINERY**

***MAKE YOUR
MONEY WORK***